

WORKSHOP ITEM SUMMARY SHEET
VILLAGE COUNCIL MEETING
October 17, 2018

Agenda Item:

Estero Parkway Access Management

Description:

The Estero Parkway consultant has completed an access management plan for Estero Parkway. The plan identifies intersection modification to improve safety and access. The Consultant has recommended several modifications including extending turn lanes, adding turn lanes, and closing full median opening.

Financial Impact:

No financial impacts at this time. These improvements will be included in the Estero Parkway Project budget.

Attachment:

1. Access Management Plan

ATTACHMENT 1



AGNOLI
BARBER &
BRUNDAGE, INC.
Professional Engineers, Planners & Surveyors

ESTERO PKWY & US-41 INTERSECTION





EXISTING CONDITIONS



PROPOSED ADDITION OF LEFT TURN DIRECTIONAL MEDIAN

ESTERO PKWY & ESTERO RIDGE / WALMART



**AGNOLI
BARBER &
BRUNDAGE, INC.**
Professional Engineers, Planners & Surveyors

SHEET
2 of 9





**AGNOLI
BARBER &
BRUNDAGE, INC.**
Professional Engineers, Planners & Surveyors

ESTERO PKWY AT OSPREY COVE





ESTERO PKWY AT BELLE LAGO





ESTERO PKWY BETWEEN BELLE LAGO & THE RESERVE



**AGNOLI
BARBER &
BRUNDAGE, INC.**
Professional Engineers, Planners & Surveyors





**AGNOLI
BARBER &
BRUNDAGE, INC.**
Professional Engineers, Planners & Surveyors

ESTERO PKWY AT THE RESERVE / CASCADES



SHEET
6 of 9



**AGNOLI
BARBER &
BRUNDAGE, INC.**
Professional Engineers, Planners & Surveyors

ESTERO PKWY AT ROOKERY POINTE

SHEET
7 of 9



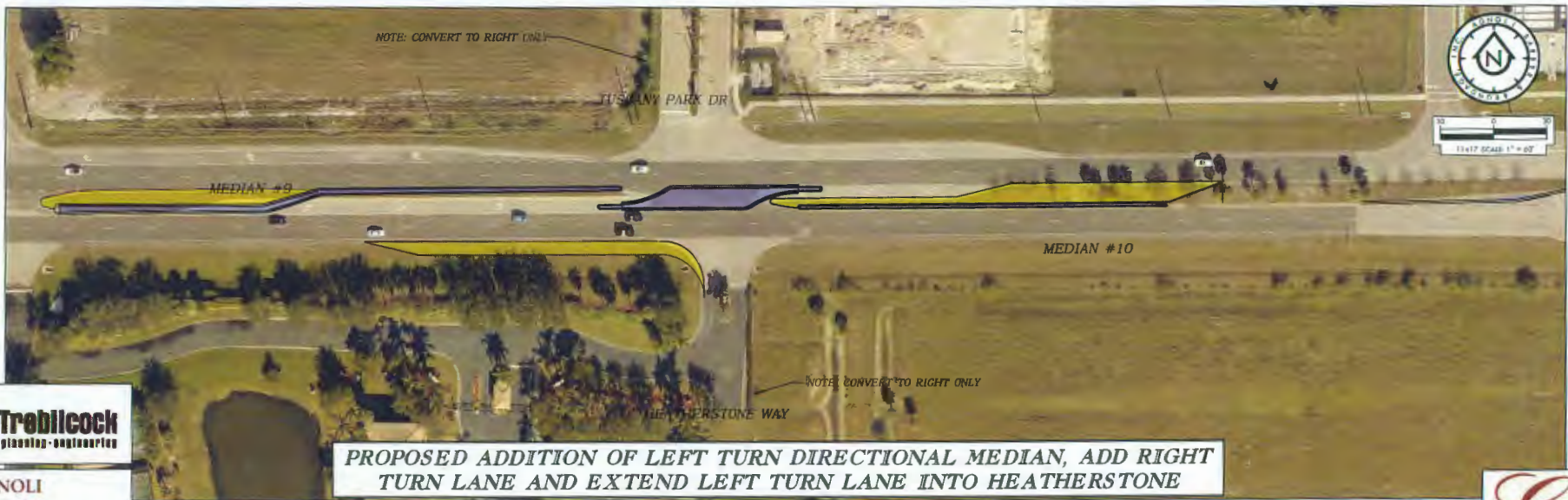

ESTERO PKWY TUSCANY PARK DR / HEATHERSTONE





EXISTING CONDITIONS



PROPOSED EASTBOUND LEFT TURN LANE IMPROVEMENT

ESTERO PKWY & THREE OAKS INTERSECTION



**AGNOLI
BARBER &
BRUNDAGE, INC.**
Professional Engineers, Planners & Surveyors

