

K:\21315 - ESTERO CROSSING\ZONING\INDIGENOUS - OPEN SPACE EXHIBIT\21315-01-INDIGENOUS-PLAN.DWG
9/25/2019 11:25 AM

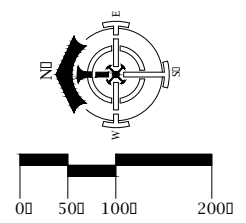
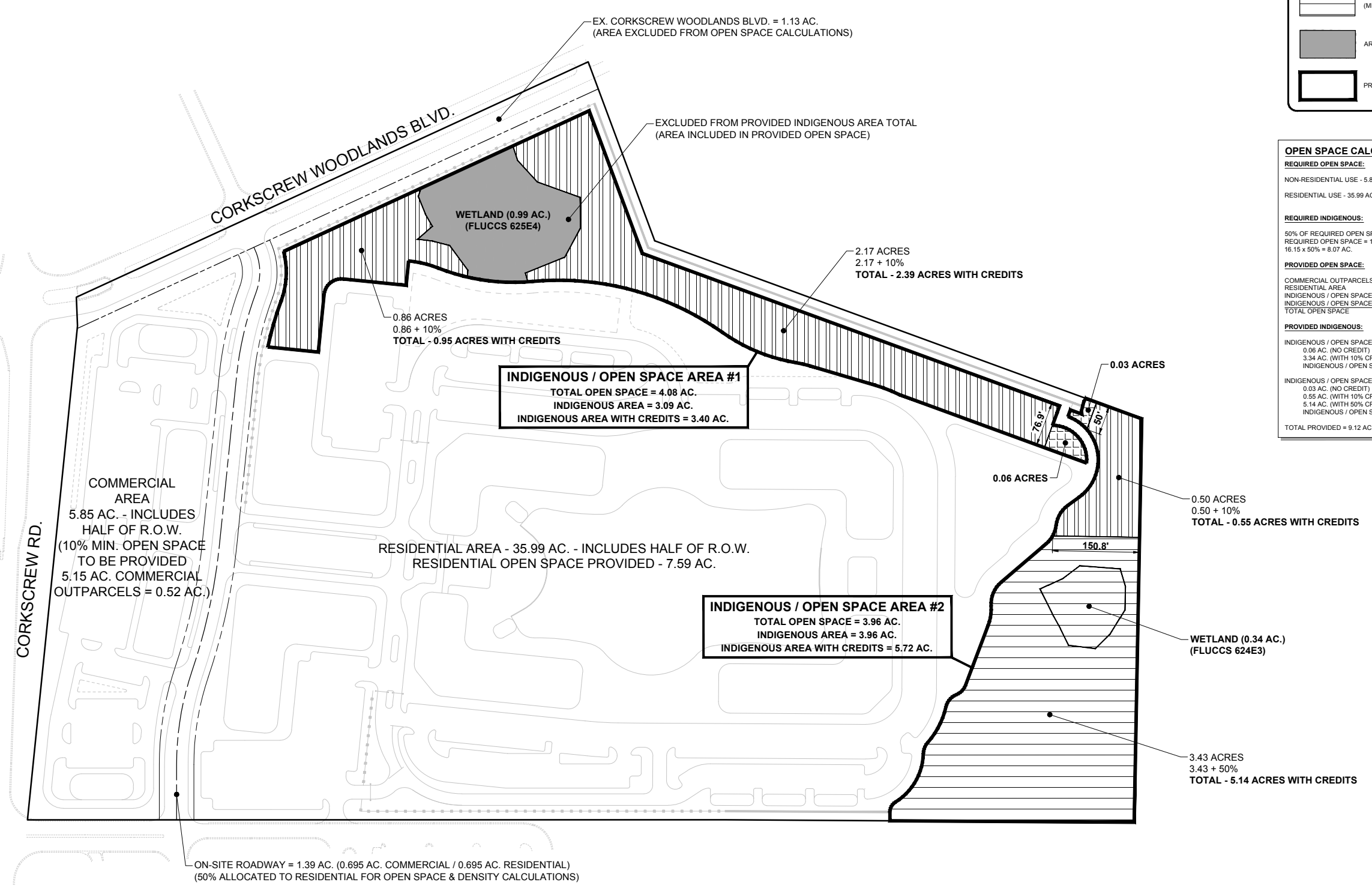

LEGEND

- AREA OF INDIGENOUS WITH NO CREDIT
- AREA OF INDIGENOUS WITH 10% CREDIT (MIN. 50' WIDE & 1/2 ACRE)
- AREA OF INDIGENOUS WITH 50% CREDIT (MIN. 100' WIDE & 3 ACRES)
- AREA OF INDIGENOUS WITH OVER 75% EXOTICS
- PRESERVE AREA BOUNDARY

OPEN SPACE CALCULATIONS:

REQUIRED OPEN SPACE:

NON-RESIDENTIAL USE - 5.85 AC. x 30% = 1.75 AC.
 RESIDENTIAL USE - 35.99 AC. x 40% = 14.40 AC.
TOTAL = 16.15 AC.

REQUIRED INDIGENOUS:

50% OF REQUIRED OPEN SPACE
 REQUIRED OPEN SPACE = 16.15
 16.15 x 50% = 8.07 AC.

PROVIDED OPEN SPACE:

COMMERCIAL OUTPARCELS (10%) 0.52 AC.
 RESIDENTIAL AREA 7.59 AC.
 INDIGENOUS / OPEN SPACE AREA #1 4.08 AC.
 INDIGENOUS / OPEN SPACE AREA #2 3.96 AC.
TOTAL OPEN SPACE = 16.15 AC.

PROVIDED INDIGENOUS:

INDIGENOUS / OPEN SPACE AREA #1
 0.06 AC. (NO CREDIT)
 3.34 AC. (WITH 10% CREDIT)
 INDIGENOUS / OPEN SPACE AREA #1 TOTAL = 3.40 AC. (WITH CREDIT)

INDIGENOUS / OPEN SPACE AREA #2
 0.03 AC. (NO CREDIT)
 5.14 AC. (WITH 50% CREDIT)
 INDIGENOUS / OPEN SPACE AREA #2 TOTAL = 5.17 AC. (WITH CREDIT)

TOTAL PROVIDED = 8.57 AC.

DELISI FITZGERALD, INC.
 Planning - Engineering - Project Management

Florida Certificate of Authorization
 Engineering LB # 26978

1605 Hendry Street
 Fort Myers, FL 33901
 (239) 418-0691
 (239) 418-0692 fax

ENGINEER OF RECORD:
 JOHN T. WOODAK, P.E. (FOR THE FIRM)
 FLORIDA P.E. NO. 58217

NOT VALID WITHOUT SEAL, SIGNATURE AND DATE

OWNER / DEVELOPER:
SD ESTERO CROSSING, LLC
 2647 PROFESSIONAL CIRCLE, SUITE 1201
 NAPLES, FL 34119
 (239) 992-7344

PROJECT:
ESTERO CROSSING

PLAN REVISIONS	DESCRIPTION
#	DATE

OPEN SPACE & INDIGENOUS PLAN

Project Manager: JTW
 Drawn By: CAS
 Checked By: JTW
 Project Number: 21315
 Part of Section(s): 35
 Township: 46 S Range: 25 E
 County, State: LEE COUNTY, FL

Status:
 FOR PERMITTING PURPOSES ONLY
 NOT FOR CONSTRUCTION

Sheet Number: 1