

CORKSCREW RD

THREE OAKS PKWY

POINT



COCONUT

VIA

LEE COUNTY
5 ac

LEE COUNTY
5 ac

Legend

-  PARCEL BY OWNER
 -  CURRENTLY IN PUBLIC OWNERSHIP
- TOTAL ALL PARCELS = 187.2 ac

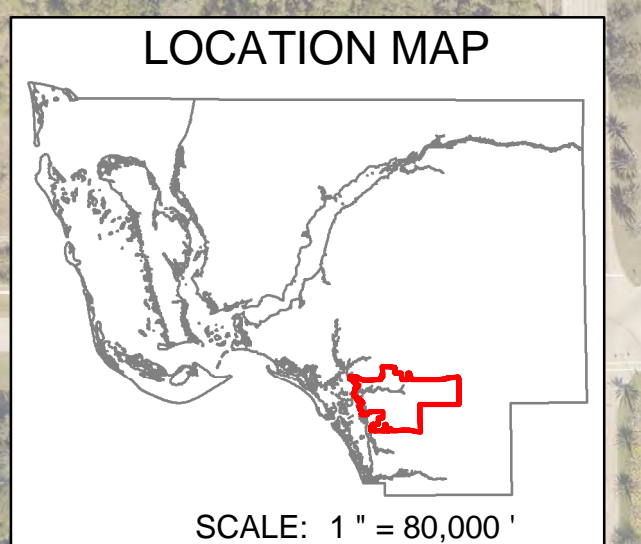

NOTES:
 1. 2019 AERIAL IMAGES FROM LEE COUNTY
 2. COORDINATE SYSTEM: NAD 1983 STATE PLANE FLORIDA WEST FIPS 0902 FEET

ESTERO HIGH SCHOOL AND PARK COMPLEX

VILLAGE OF ESTERO



SCALE:	1" = 200'
DRAWN BY:	EJR
CHECKED BY:
DATE:	3/23/2020
SHEET:	1 of 1

Z:\Estero Park and Open Space\MXD\School_ParkComplexUpdate\School_ParkComplex.mxd