

VEGETATION MAP

ATTACHMENT 4

FLUGGS	Description	Acreage
262	Fallow pasture	1.8 ac.
321M2	Palmetto Prairies/Melaleuca invaded (26-50%)	7.2 ac.
321M4	Palmetto Prairies/Melaleuca invaded (76-90%)	2.9 ac.
411M2	Pine Flatwoods/Melaleuca invaded (26-50%)	1.2 ac.
411M3	Pine Flatwoods/Melaleuca invaded (51-75%)	5.7 ac.
411M4	Pine Flatwoods/Melaleuca invaded (76-90%)	0.9 ac.
425M3	Temperate Hardwoods/Melaleuca invaded (51-75%)	0.3 ac.
**510D	Ditch	0.7 ac.
*619M	Hydric Melaleuca	47.2 ac.
740	Disturbed Land	0.2 ac.
**742	Borrow Areas	7.5 ac.
*742/619M	Borrow Areas/Hydric Melaleuca	0.4 ac.
743	Spoil Areas	0.1 ac.
	TOTAL	76.1 ac.

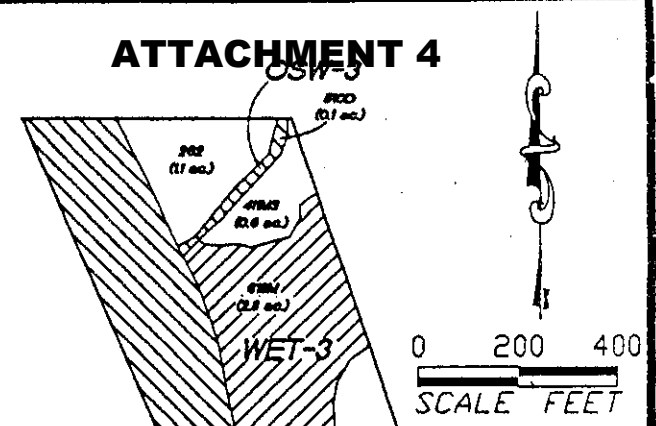

- Notes:
- Mapping based on photointerpretation of 1" = 200' scale 2002 aerial photography and ground truthing in May 2004.
 - Property boundary obtained from JRI Engineering, Inc.

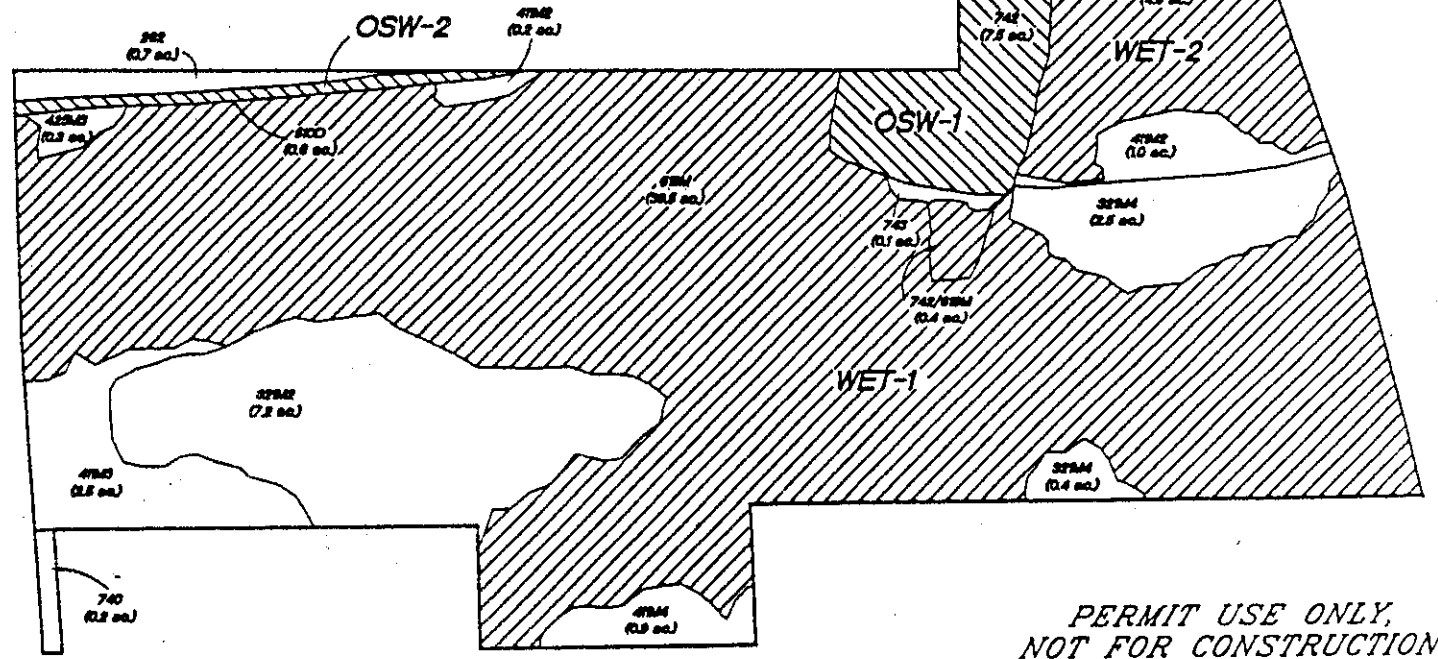

ADD/REVISED SUBMITTAL
 JAN 27 2005
 FORT MYERS SERVICE CENTER

APPLICATION NUMBER
 040923-18#

- Vegetation lines
- Jurisdictional Wetlands (47.6 ac.)
- Jurisdictional Other Surface Waters (8.2 ac.)

**PERMIT USE ONLY,
 NOT FOR CONSTRUCTION**
 December 17, 2004 2:10:36 p.m.
 Drawing: LCSH10COEVEG.DWG (DCS)

**W. DEXTER BENDER
 AND ASSOCIATES**
 ENVIRONMENTAL & MARINE CONSULTING
 FORT MYERS 239/334-3680
 PORT CHARLOTTE 941/255-1462

THREE OAKS SCHOOL
76.1± Acre Parcel **EXHIBIT 3.0**