

PLAN VIEW

SCALE 1" = 20'

General Notes

- PLANT AND LANDSCAPE MATERIALS SHALL CONFORM TO THE STANDARDS FOR FLORIDA NO. 1, AS GIVEN IN THE GRADES AND STANDARDS FOR NURSERY PLANTS, PARTS I & II AS PREPARED BY FLORIDA DEPARTMENT OF AGRICULTURE AND CONSUMER SERVICES.
- ALL UTILITIES THAT ARE KNOWN TO THE LANDSCAPE ARCHITECT ARE LOCATED ON THE PLAN. FOR EXISTING OR PROPOSED UTILITIES:
  - NO TREE SHALL BE PLANTED WHERE IT COULD CONFLICT WITH OVER-HEAD POWER LINES AT MATURE HEIGHT.
  - NO TREE, SHRUBS, HEDGES OR VINES SHALL BE PLANTED WITHIN FIVE (5) FEET OF ANY EXISTING OR PROPOSED UTILITY POLE, GUY WIRE OR PAD MOUNTED TRANSFORMER.
  - LARGE TREES (HEIGHT AT MATURITY OF MORE THAN 30 FEET) SHALL BE PLANTED NO CLOSER THAN A HORIZONTAL DISTANCE OF 30 FEET FROM THE NEAREST OVER-HEAD POWERLINE.
  - MEDIUM HEIGHT TREE (HEIGHT AT MATURITY BETWEEN 20 AND 30 FEET) SHALL BE OFFSET AT LEAST TWENTY (20) FEET.
  - SMALL TREES (HEIGHT AT MATURITY OF LESS THAN 20 FEET) REQUIRE NO OFFSET.
  - PALMS SHOULD BE PLANTED AT A DISTANCE EQUAL TO OR GREATER THAN THE AVERAGE FROND LENGTH PLUS 2 FEET FROM POWER LINES.
- THE CONTRACTOR SHALL ENSURE THAT ALL PLANTING ISLANDS AND OTHER AREAS SHALL BE CLEAN OF TRASH, CONSTRUCTION DEBRIS, OR OTHER WASTE MATERIALS TO A DEPTH OF 24 INCHES PRIOR TO LANDSCAPE INSTALLATION.
- IT IS THE CONTRACTOR'S RESPONSIBILITY TO INSURE THAT ALL PLANT BED AREAS HAVE PROPER DRAINAGE FOR OPTIMUM GROWTH OF LANDSCAPE MATERIAL BEFORE INSTALLATION BEGINS. EXISTING DRAINAGE PATTERN SHALL NOT BE ALTERED OR DEFLECTED BY NEW LANDSCAPING.
- PLANT ALL TREES AND PALMS (2 INCH - 4 INCH) ABOVE FINISHED GRADE. TREES INSTALLED OR SAVED TOO DEEP SHALL BE RESET TO THIS STANDARD. REMOVE THE TOP ONE-THIRD (1/3) OF THE WIRE STAKES ON ALL B & B MATERIAL.
- ALL HEDGES AND GROUNDCOVERS TO BE PLANTED LEAVING SPACE BETWEEN PLANTS AND BUILDINGS, WALLS AND FENCES.
- ALL PLANT BEDS AND TREE RINGS SHALL BE TREATED WITH PRE-EMERGENT HERBICIDE AND THEN TOP-DRESSED WITH 3-INCH DEEP LAYER OF COMMERCIAL PINE BARK NUGGETS. CONTRACTOR SHALL INSTALL WOVEN WEED BARRIER FABRIC IN ALL SHRUB/GROUNDCOVER BEDS.
- HAND DIGGING HOLES FOR INSTALLING PROPOSED TREES IN CLOSE PROXIMITY TO UTILITIES IS REQUIRED TO AVOID CONFLICTS.
- ALL EXOTIC VEGETATION TO BE REMOVED FROM THE SITE PRIOR TO THE ISSUANCE OF A CERTIFICATE OF OCCUPANCY.

48 HOURS BEFORE DIGGING CALL TOLL FREE 8-1-1 SUNSHINE/911 NOTIFICATION CENTER

Additional Notes

- NEW SOD SHALL BE ST. AUGUSTINE FLORITAM. THE QUANTITY SHOWN ON THE PLANT LIST IS AN ESTIMATE AND CONTRACTOR SHALL DETERMINE EXACT QUANTITIES IN THE FIELD. SOD AREAS TO BE MAINTAINED BY THE CONTRACTOR FROM THE TIME OF INSTALLATION TO THE TIME OF FINAL ACCEPTANCE.
- EXISTING AND PROPOSED LANDSCAPING IS TO BE MAINTAINED PER JURISDICTIONS CLEAR SIGHT TRIANGLE REGULATIONS.
- THE LANDSCAPE ARCHITECT MAY INSPECT TREES AND SHRUBS WHETHER AT PLACE OF GROWTH OR AT SITE BEFORE PLANTING, FOR COMPLIANCE WITH THE REQUIREMENTS FOR GENUS, SPECIES, VARIETY, SIZE AND QUALITY. LANDSCAPE ARCHITECT RETAINS RIGHT TO FURTHER INSPECT TREES AND SHRUBS FOR SIZE AND CONDITION OF BALLS AND ROOT SYSTEMS, INSECTS, INJURIES AND LATENT DEFECTS, AND TO REJECT UNSATISFACTORY OR DEFECTIVE MATERIAL AT ANY TIME DURING PROGRESS OF WORK. REMOVE REJECTED TREES OR SHRUBS IMMEDIATELY FROM PROJECT SITE.
- ALL OF THE MINIMUMS FOR EACH PLANT SPECIFIED WITHIN THE PLANT LIST ARE REQUIRED TO BE MET. IF ANY OF THE MINIMUMS ARE NOT MET, THE INSTALLED MATERIAL MAY OR MAY NOT BE REJECTED ON A CASE BY CASE BASIS BY THE LANDSCAPE ARCHITECT, OWNER, OR JURISDICTION.
- NO SUBSTITUTIONS WILL BE ACCEPTABLE. IF SPECIFIED LANDSCAPE MATERIAL IS NOT OBTAINABLE, SUBMIT PROOF OF NON-AVAILABILITY TO LANDSCAPE ARCHITECT AND JURISDICTION TOGETHER WITH THE PROPOSAL FOR USE OF EQUIVALENT MATERIAL.
- IN EVENT OF DISCREPANCY, THE PLANTING PLAN SHALL TAKE PRECEDENCE OVER THE PLANT LIST.
- TREES TO BE STAKED ONLY IF REQUIRED AS DEEMED NECESSARY BY OWNER AND LANDSCAPE ARCHITECT TO ASSURE HEALTH, SAFETY AND WELFARE (INCLUDES BUT NOT LIMITED TO ALL CURVED GARBAGE, TALL ROYALS, CURVED AND LEANING SPECIMEN). ALL WOOD STAKES TO BE PAINTED FOREST GREEN. STAKING PROCEDURES SHALL BE STANDARD CONTRACTOR PRACTICE CREATING NO TRUNK DAMAGE OR FUTURE STRANGULATION OF TREE.
- ALL PLANT MATERIAL SHALL BE PLANTED WITH 'TERRA-SORB AG' OR AN APPROVED EQUAL IN ACCORDANCE WITH THE MANUFACTURER'S RECOMMENDATIONS FOR THE RATE OF APPLICATION.
- AN AUTOMATIC IRRIGATION SYSTEM WILL BE PROVIDED WHICH MEETS OR EXCEEDS THE FULL REQUIREMENTS OF THE LAND DEVELOPMENT REGULATIONS. THE OWNER WILL SUPPLY ALL PROPOSED PLANT MATERIAL WITH 100% IRRIGATION (AUTOMATIC) COVERAGE (WITH 50% OVERLAP MINIMUM WITHIN TEN DAYS OF INITIAL INSTALLATION).
- CONTRACTOR TO INSTALL THE IRRIGATION SYSTEM PER THE JURISDICTIONS REGULATIONS TO CONFORM TO THE LANDSCAPE DESIGN.
- ALL IRRIGATION SHALL USE THE LOWEST QUALITY WATER AVAILABLE WHICH ADEQUATELY AND SAFELY MEETS THE NEEDS OF THE SYSTEM. STORM WATER REUSE, RECLAIMED WATER USE, GRAY WATER IRRIGATION SYSTEMS AND/OR SHALLOW WELLS SHALL BE USED. THE USE OF POTABLE WATER FOR IRRIGATION WILL NOT BE ALLOWED.
- THERE SHALL BE 3-FT. MINIMUM CLEARANCE FROM LANDSCAPE PLANTS TO THE EDGE OF THE METERS LESS THAN 3-IN. AND 10-FT. FOR METERS 3-INCH. AND LARGER.
- THERE SHALL BE 7.5-FT. MINIMUM CLEARANCE FROM THE FRONT AND BOTH SIDES AND 4-FT. FROM THE BACK FOR ALL FIRE HYDRANTS.
- NO TREE SHALL BE PLANTED WITHIN 10-FT. OF ANY WATER OR SEWER MAIN.
- NO TREE WILL BE PLANTED WITHIN 3-FT. OF THE PROPERTY LINE OR 6-FT. OF ANY ABOVE OR UNDERGROUND UTILITY.
- THE PROPOSED ROADWAY BUFFERS ARE NOT LOCATED IN POTENTIAL FUTURE RIGHT-OF-WAY RESERVATION SETBACKS.
- NO CLEARING WITH HEAVY EQUIPMENT, FILLING, OR PLACEMENT OF IMPROVEMENTS OR UTILITY LINES SHALL OCCUR WITHIN THE PROTECTED ROOT ZONE OF ANY CANOPY TREE TO BE SAVED.

Landscape Requirements

	REQUIRED/ PERMITTED	PROVIDED
<b>TREE PLANTING REQUIREMENT</b>		
SITE AREA	36,101 SF (0.8 AC)	11 TREES
TREES - 1/3,500 SF INCLUDES	(2) PROPOSED TREES = 2 TREES (1) EXISTING 1" OAK = 5 TREES (1) EXISTING 1" PALM = 4 TREES*	11 TREES
* 1 TREE CREDIT USED FOR WEST BUFFER CALCULATIONS		
VEHICLE USE AREA (VUA) LANDSCAPE AREA (10%)	18,934 SF 8 TREES	1,893 SF 8 TREES
<b>LANDSCAPE BUFFERS</b>		
ROADWAY LANDSCAPE BUFFER		
EAST - BEN HILL GRIFFIN PKWY - 40' WIDE BUFFER EASEMENT (187 LF) TYPE 'D' BUFFER	(5) TREES / 100 LF (187 LF / 100 LF X 5) = 10 TREES (3) EXISTING PALMS = 1 TREE (6) PROPOSED PALMS = 2 TREES	10 TREES
WEST - INTERIOR ROAD - 20' WIDE BUFFER (139 LF) TYPE 'D' BUFFER	(1) EXISTING TREES = 1 TREE (6) PROPOSED TREES = 6 TREES	161 SHRUBS
NORTH - ENTRANCE DRIVE - 20' WIDE BUFFER (203 LF) TYPE 'D' BUFFER	(5) TREES / 100 LF (203 LF / 100 LF X 5) = 10 TREES (5) EXISTING PALMS = 5 TREES (5) PROPOSED TREES = 5 TREES	10 TREES
SOUTH - ADJACENT COMMERCIAL - 5' WIDE BUFFER (170 LF) TYPE 'A' BUFFER	(4) TREES / 100 LF (170 LF / 100 LF X 4) = 7 TREES	7 TREES
<b>BUILDING PERIMETER PLANTINGS</b>		
BUILDING GRASS FLOOR AREA	2,020 SF	
REQUIRED LANDSCAPE AREA (10%)	202 SF	238 SF

Overall

	REQUIRED/ PERMITTED	PROVIDED
<b>CANOPY TREES:</b>	53 TREES	53 TREES
INCLUDES	(3) EXISTING TREES = 11 TREES (3) EXISTING PALMS = 1 TREE (3) EXISTING SYLVESTER PALMS = 5 TREES (6) PROPOSED PALMS = 2 TREES (34) PROPOSED TREES = 34 TREES	
<b>BUFFER SHRUBS:</b>	--	278 SHRUBS
<b>OTHER VEGETATION:</b>	--	842 PLANTS
<b>TOTAL VEGETATION:</b>		1,178 PLANTS
<b>NATIVE VEGETATION TREES (MIN. 75% NATIVE):</b>	31 TREES	34 TREES (85%)
<b>SHRUBS (MIN. 50% NATIVE):</b>	560 SHRUBS	577 SHRUBS (52%)

Plant List

SYM	BOTANICAL NAME/ COMMON NAME	HEIGHT/ SPREAD	SPECIFICATION	NATIVE	DROUGHT TOLERANT	TOTAL
I C	ILEX CASINE DAHOON HOLLY	12' HT. 6' SPR.	3" CAL. FIELD GROWN, B&B	Y	M	9
CD	COCCOLOBA DIV ERSIFOLIA PIGEON PLUM	12' HT. 6' SPR.	3" CAL. FIELD GROWN, B&B	Y	H	6
QV	QUERCUS VIRGINIANA LIVE OAK	12' HT. 6' SPR.	3" CAL. 5' CT. MIN. FIELD GROWN, B&B	Y	H	13
SP	SABAL PALMETTO SABAL PALM	10' - 14' C.T.	AS SHOWN, BOOTED STAGGERED HEIGHTS	Y	H	6
TH	TABEQUIA HETEROPHYLLA PINK TRUMPET TREE	12' HT. 6' SPR.	3" CAL. 5' CT. MIN. FIELD GROWN, B&B	N	H	6
CH-R	CHRYSOBALANUS ICACO 'RED TIP' RED TIP COCOPLUM	24' X 18'	7 GAL., 24" O.C. FULL TO BASE	Y	H	174
PHO	PHOENIX ROSEBLENII PYGMY DATE PALM	4' - 5' OAH	TRIPLE TRUNK, FULL HEAD, EQ. HTS.	N	H	2
POD	PODOCARPUS MACROPHYLLUS PODOCARPUS	24' X 18'	7 GAL., 30" O.C. FULL TO BASE	N	H	21
SC4	SCHOFFLERA ABORICOLA 'TRINETTE' VARIEGATED ARBICOLA	24' X 18'	7 GAL., 24" O.C. FULL TO BASE	N	H	86
STR	STRELTZIA REGENAE BIRD OF PARADISE	30' X 24'	7 GAL., AS SHOWN FULL TO BASE	N	M	3
VIB	VIBURNUM OBOVATUM WALTER'S VIBURNUM	24' X 18'	7 GAL., 24" O.C. FULL TO BASE	Y	H	176
DIA	DIANELLA TASMANICA 'VARIEGATA' VARIEGATED FLAX LILY	18' X 16'	3 GAL., 24" O.C. FULL TO BASE	N	H	165
ILE	ILEX VOMITORIA 'STOKES DWARF' DWARF YALPON HOLLY	18' X 16'	3 GAL., 24" O.C. FULL TO BASE	Y	H	141
JUN	JUNIPERUS HORIZONTALIS 'WILTON' BLUE RUG JUNIPER		3 GAL., 24" O.C. FULL TO BASE	N	H	105
LIR	LIRIOPE MUSCARI LIRIOPE		1 GAL., 24" O.C. FULL TO BASE	N	M	55
MU-H	MULLENBERGIA CAPILLARIS PINK MUHLY GRASS	18' X 18'	3 GAL., 30" O.C. FULL TO BASE	Y	H	15
PH-X	PHILODENDRON 'XANADU' DWARF PHILODENDRON	18' X 18'	3 GAL., 24" O.C. FULL TO BASE	N	M	9
RHA	RHAPHOLEPIS INDICA INDIAN HAWTHORN	18' X 14'	3 GAL., 24" O.C. FULL TO BASE	N	H	98
ZAM	ZAMIA PUMILA COONTIE	18' X 18'	7 GAL., 30" O.C. FULL TO BASE	Y	H	71
SOD	STENOTAPHRUM SECUNDATUM ST. AUGUSTINE FLORITAM GRASS		DISEASE FREE, LAID TIGHTLY, EVEN UNIFORM	N	M	TBD.

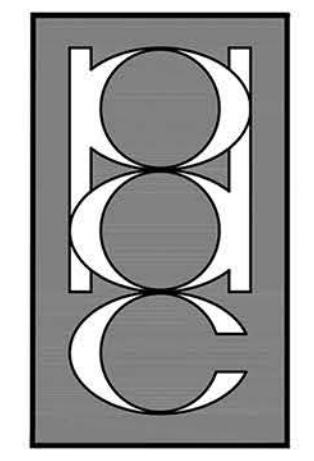
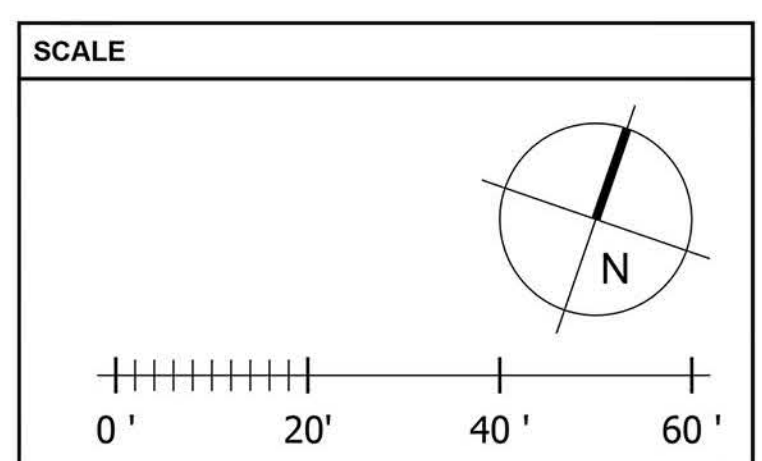

PATRICK D. CUNNINGHAM, LLC  
 519 Sapphire Drive  
 Sarasota, FL 34234  
 O: 941.351.8915  
 p.dunningham.LLCo@bdg.com

**bdg architects**  
 201 South Tryon Street  
 Suite 525  
 Charlotte, NC 28202  
 P: 704.981.8951  
 Lic. # AA - 0003590  
 www.bdgplp.com



**FIFTH THIRD BANK**  
**CORKSCREW ROAD**  
**BRANCH**  
 10870 MIROMAR OUTLET DRIVE  
 ESTERO, FL 33928

**INFINITY**  
 INFINITY ENGINEERING GROUP, PLLC  
 1208 East Kennedy Boulevard  
 Suite 230  
 Tampa, FL 33602  
 [p]: 813.695.6649  
 [f]: 813.445.4211  
 www.iggroup.net  
 Certificate No. 27889  
 IEG JOB NO. 15-160.00

SEAL PATRICK D. CUNNINGHAM  
 FL REG. NO. LA 0001669  
 11.23.2020  
 DATE

ISSUE/BY	DATE	DESCRIPTION
	08-17-20	PERMIT SET

PROJECT INFORMATION BLOCK

JOB #:	193504
DATE:	08-17-2020
DRAWN BY:	PC
CHECKED BY:	PC

SHEET TITLE  
**LANDSCAPE PLAN**  
 SHEET NUMBER  
**LP01.01**



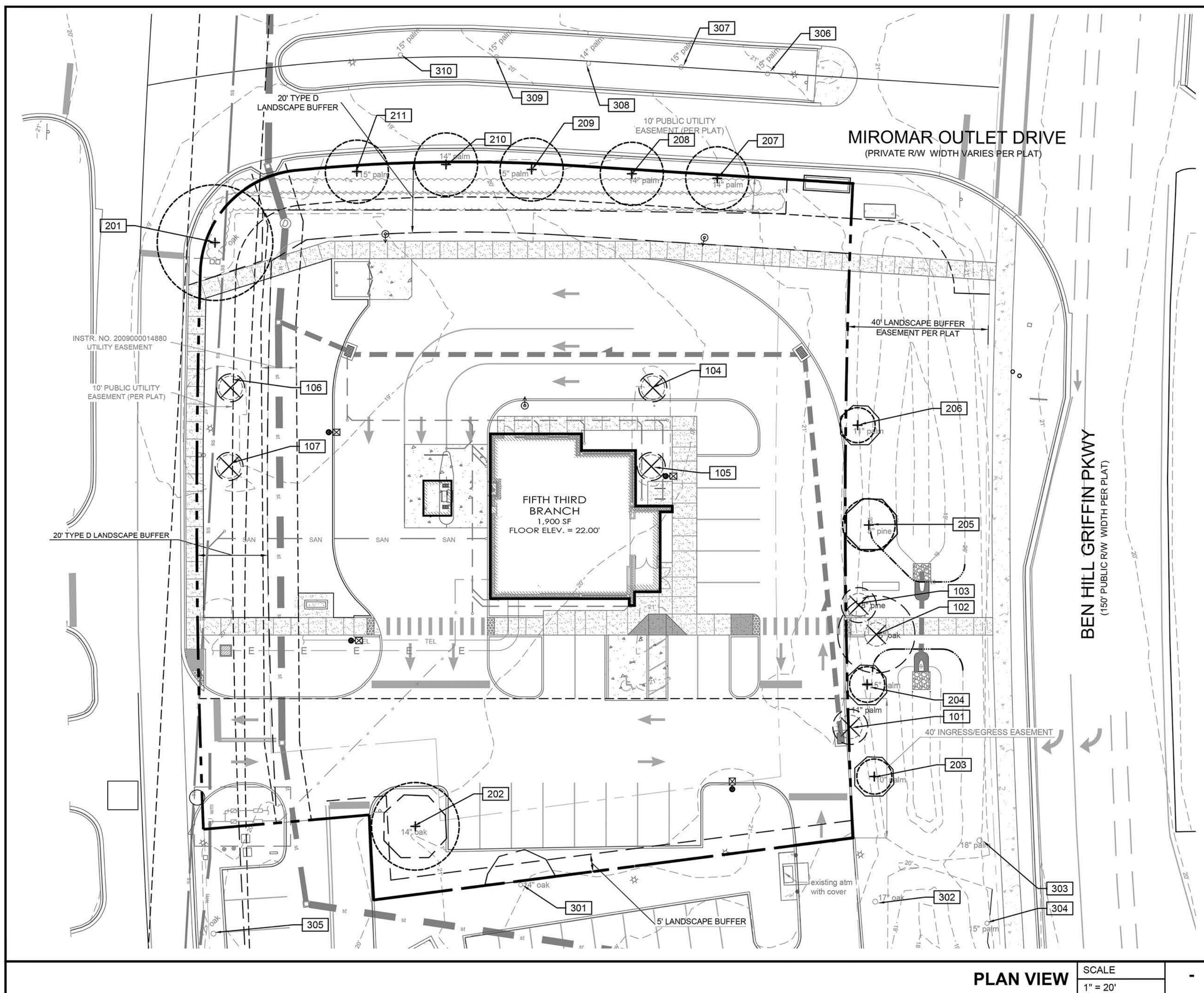

PLAN VIEW SCALE 1" = 20'

EXISTING TREES: (TO BE REMOVED)

NO.	TREE SPECIES	DBH	ACTION
101	PALM SPP.	10"	TO BE REMOVED
102	OAK SPP.	6"	TO BE REMOVED
103	PINE SPP.	8"	TO BE REMOVED
104	HOLLY SPP.	4"	TO BE REMOVED
105	HOLLY SPP.	4"	TO BE REMOVED
106	HOLLY SPP.	4"	TO BE REMOVED
107	HOLLY SPP.	4"	TO BE REMOVED

EXISTING TREES: (TO REMAIN)

NO.	TREE SPECIES	DBH	CANOPY	ACTION	CRZ DIA. (FEET)
201	OAK SPP.	17"	35'	TO BE PROTECTED	27'
202	OAK SPP.	14"	25'	TO BE PROTECTED	19'
203	SABAL SPP.	10"	12'	TO BE PROTECTED	12'
204	SABAL SPP.	15"	12'	TO BE PROTECTED	12'
205	PINE SPP.	8"	16'	TO BE PROTECTED	16'
206	SABAL SPP.	11"	12'	TO BE PROTECTED	12'
207	PALM SPP.	14"	18'	TO BE PROTECTED	12'
208	PALM SPP.	14"	18'	TO BE PROTECTED	12'
209	PALM SPP.	15"	18'	TO BE PROTECTED	12'
210	PALM SPP.	14"	18'	TO BE PROTECTED	12'
211	PALM SPP.	15"	18'	TO BE PROTECTED	12'

EXISTING TREES: (OFF-SITE)

NO.	TREE SPECIES	DBH	CANOPY	ACTION	CRZ DIA. (FEET)
301	OAK SPP.	14"	27'	TO BE PROTECTED	21'
302	OAK SPP.	17"	36'	TO BE PROTECTED	NA
303	PALM SPP.	18"	18'	TO BE PROTECTED	NA
304	PALM SPP.	18"	18'	TO BE PROTECTED	NA
305	OAK SPP.	17"	36'	TO BE PROTECTED	NA
306	PALM SPP.	15"	18'	TO BE PROTECTED	NA
307	PALM SPP.	15"	18'	TO BE PROTECTED	NA
308	PALM SPP.	14"	18'	TO BE PROTECTED	NA
309	PALM SPP.	15"	18'	TO BE PROTECTED	NA
310	PALM SPP.	15"	18'	TO BE PROTECTED	NA

\*\* TREE PROTECTION BARRICADES TO BE MEASURED FROM OFF-SITE TREE, BUT INSTALLED ON PROPERTY.

Notes:

- TREE CALCULATIONS ABOVE ARE PER THE LAND DEVELOPMENT REGULATIONS.
- THE CITY MAY WISH TO RELOCATE THE EXISTING TREES AT OWNER'S EXPENSE TO COUNTY PROPERTIES WITHIN THE DISTRICT.
- A TREE REMOVAL PERMIT WILL BE REQUIRED PRIOR COMMENCEMENT OF DEVELOPMENT ACTIVITY.
- THE CONDITION OF THE TREES LISTED ARE BASED ON A VARIETY OF MATERIALS, AS WELL AS FIELD OBSERVATIONS, AND ARE TO BE USED AS REFERENCE ONLY AND IS NOT TO BE USED FOR TREE PERMITTING. A CERTIFIED ARBORIST, NOT THE LANDSCAPE ARCHITECT IS RESPONSIBLE FOR ANY TREE EVALUATION REQUIRED BY THE CITY.
- A CERTIFIED ARBORIST IS TO PROVIDE THE FINAL TREE DISPOSITION PLAN AT TIME OF TREE PERMITTING. THE VALUATION OF TREES SHALL BE APPRAISED USING THE COUNCIL OF TREE AND LANDSCAPE APPRAISERS GUIDE FOR PLANT APPRAISAL, LATEST EDITION. TREE BARRICADES FOR TREES TO BE PRESERVED DURING CONSTRUCTION SHALL BE LOCATED AT THE DRIP LINE, UNLESS OTHERWISE APPROVED BY THE ENVIRONMENTAL REVIEW STAFF, PRIOR TO COMMENCEMENT OF CONSTRUCTION.
- DRIP LINES CAN BE ESTIMATED BASED ON 1-FOOT OF RADIUS (OUT FROM THE TRUNK IN ALL DIRECTIONS) FOR EVERY 1-INCH DBH (DIAMETER AT BREAST HEIGHT).
- THE AREA WITHIN THE DRIP LINE SHALL REMAIN UNDISTURBED.
- THE FOLLOWING ACTIVITIES ARE PROHIBITED WITHIN THE DRIP LINE OF PRESERVED TREES:
  - IMPROVEMENTS, FILL, MACHINERY AND VEHICLE TRAVEL OR PARKING
  - UNDERGROUND UTILITIES
  - GRADE CHANGES, COMPACTION OF SOIL, OR EXCAVATION
  - STORAGE OR CONSTRUCTION MATERIALS.
- THE TREE PROTECTION BARRICADES SHALL CONSIST OF CHAINLINK FENCE OR ORANGE SAFETY FENCE PER THE DETAIL UNLESS OTHERWISE APPROVED BY THE BUILDING AND DEVELOPMENT SERVICES.

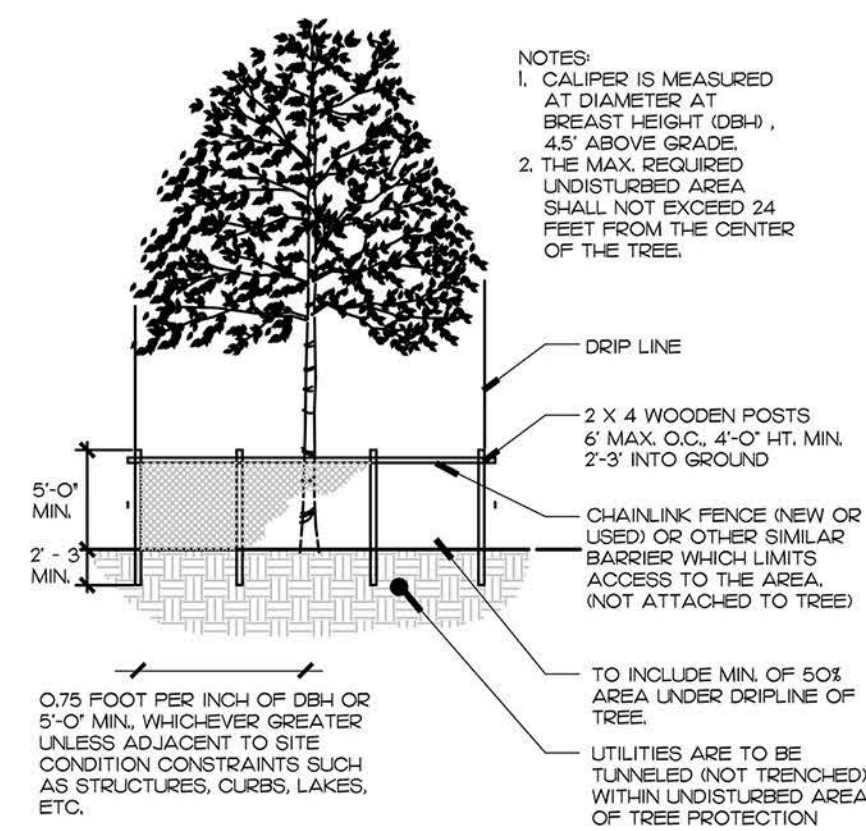

TYPICAL TREE PROTECTION DETAIL NOT TO SCALE

NOTES:  
 1. CALIPER IS MEASURED AT DIAMETER AT BREAST HEIGHT (DBH), 4.5' ABOVE GRADE.  
 2. THE MAX. REQUIRED UNDISTURBED AREA SHALL NOT EXCEED 24 FEET FROM THE CENTER OF THE TREE.

ALL EXISTING TREES TO BE PROTECTED DURING ANY LAND CLEARING AND/OR CONSTRUCTION AS FOLLOWS:

(A) PRIOR TO ANY LAND CLEARING OPERATIONS, TEMPORARY BARRIERS SHALL BE INSTALLED AROUND ALL TREES TO REMAIN WITHIN THE LIMITS OF LAND CLEARING OR CONSTRUCTION AND SHALL REMAIN UNTIL THE COMPLETION OF THE WORK.

TREE PROTECTION SHALL COMPLY WITH THE JURISDICTIONS REGULATIONS.

(B) NO MATERIALS, TRAILERS, EQUIPMENT OR CHEMICALS SHALL BE STORED, OPERATED, DUMPED, BURIED OR BURNED WITHIN THE PROTECTED AREAS.

NO ATTACHMENT, WIRES (OTHER THAN PROTECTIVE GUY WIRES), SIGNS OR PERMITS SHALL BE ATTACHED TO A PROTECTED TREE.

(C) PROTECTED TREES SHALL BE PRUNED TO RESTORE THIS NATURAL SHAPE AND FERTILIZED AS NECESSARY TO COMPENSATE FOR ANY LOSS OF ROOTS AND TO STIMULATE ROOT GROWTH.

ANY DAMAGE TO TREE CROWNS OR ROOT SYSTEMS SHALL BE REPAIRED IMMEDIATELY AFTER DAMAGE OCCURS.

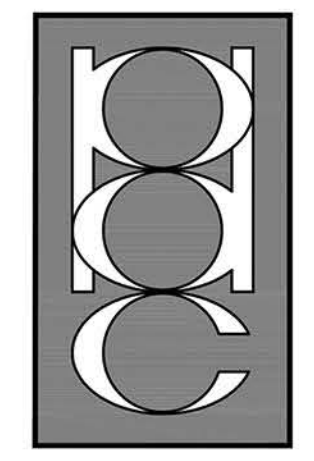

PATRICK D. CUNNINGHAM, LLC  
 519 Sapphire Drive  
 Sarasota, FL 34234  
 O: 941.351.8915

bdg architects

201 South Tryon Street  
 Suite, 525  
 Charlotte, NC 28202  
 P: 704.981.8951  
 Lic. #: AA-0003590  
 www.bdgip.com



FIFTH THIRD BANK  
 CORKSCREW ROAD  
 BRANCH  
 10870 MIROMAR OUTLET DRIVE  
 ESTERO, FL 33928



INFINITY ENGINEERING GROUP, PLLC  
 1208 East Kennedy Boulevard  
 Suite 230  
 Tampa, FL 33602  
 (p): 813.695.4649  
 (f): 813.445.4211  
 www.iggroup.net  
 Certificate No. 27889  
 IEG JOB NO. 15-180.00

SEAL PATRICK D. CUNNINGHAM  
 FL. REG. NO. LA 0001669

11.23.2020  
 DATE

ISSUE/BY	DATE	DESCRIPTION
	08-17-20	PERMIT SET

PROJECT INFORMATION BLOCK  
 JOB #: 193504  
 DATE: 08-17-2020  
 DRAWN BY: PC  
 CHECKED BY: PC

SHEET TITLE  
 EXISTING TREE PLAN  
 SHEET NUMBER

LP02.01

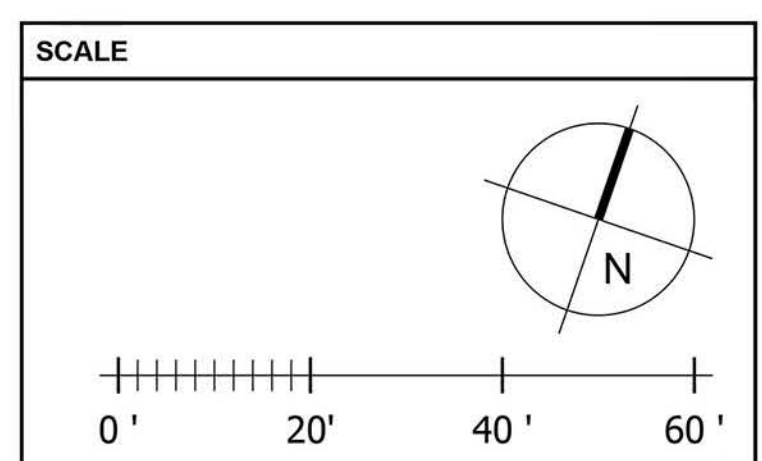

KEY

- EXISTING TREE TO BE REMOVED
- EXISTING TREE/PALM I.D. TAG DBH & COMMON NAME
- EXISTING TREE/PALM TO REMAIN
- EXISTING OFF-SITE TREE/PALM
- TPZ - TREE PROTECTION ZONE

48 HOURS BEFORE DIGGING  
 CALL TOLL FREE  
 8-H  
 SUNSHINE.COM  
 NOTIFICATION CENTER



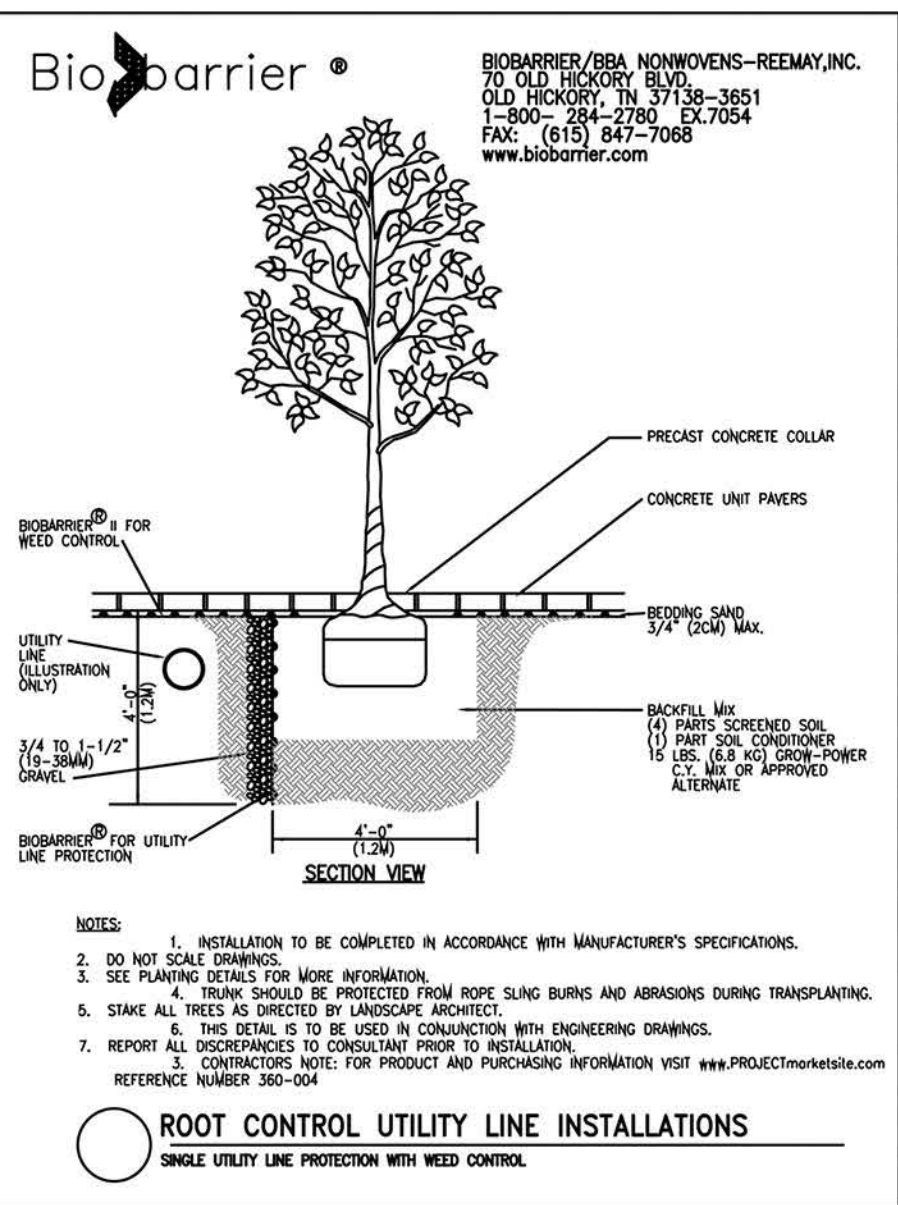
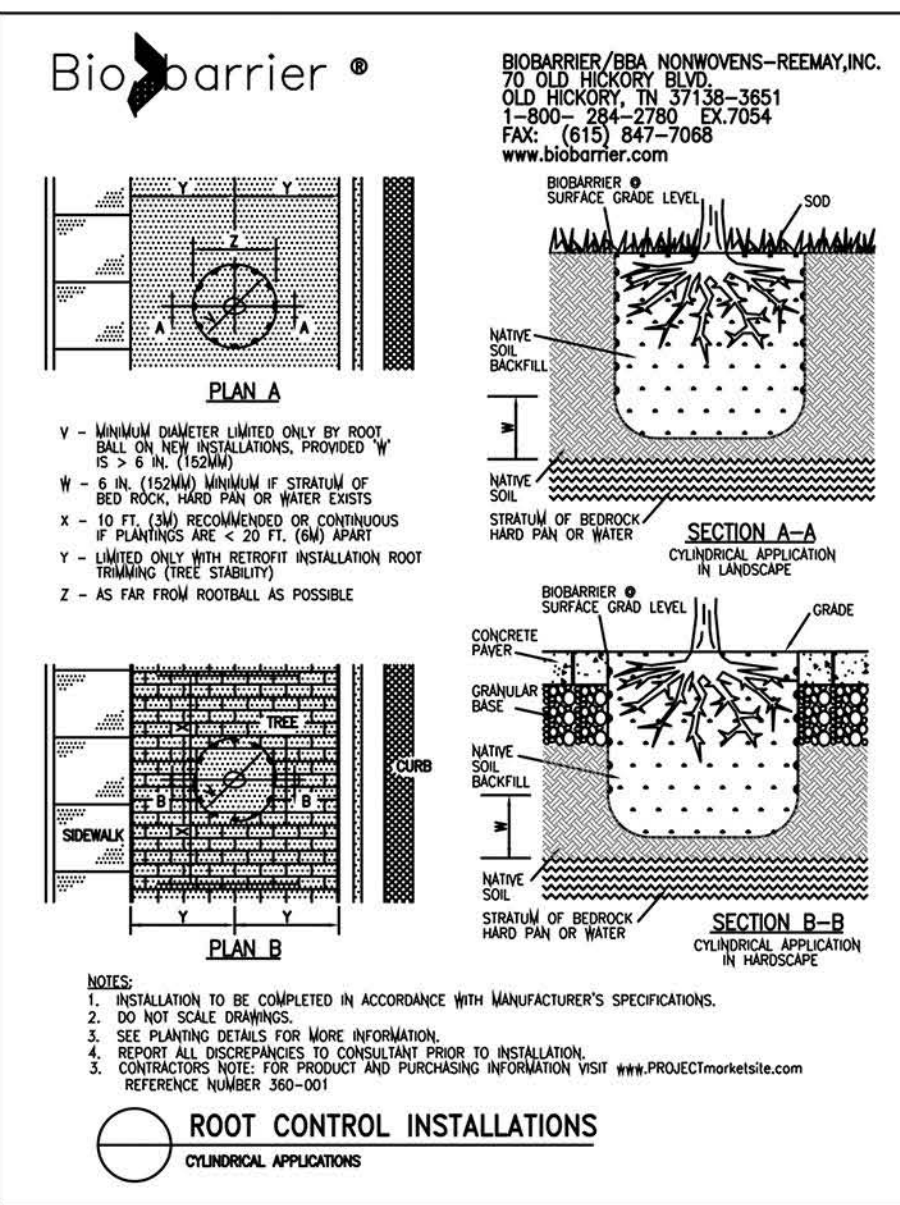
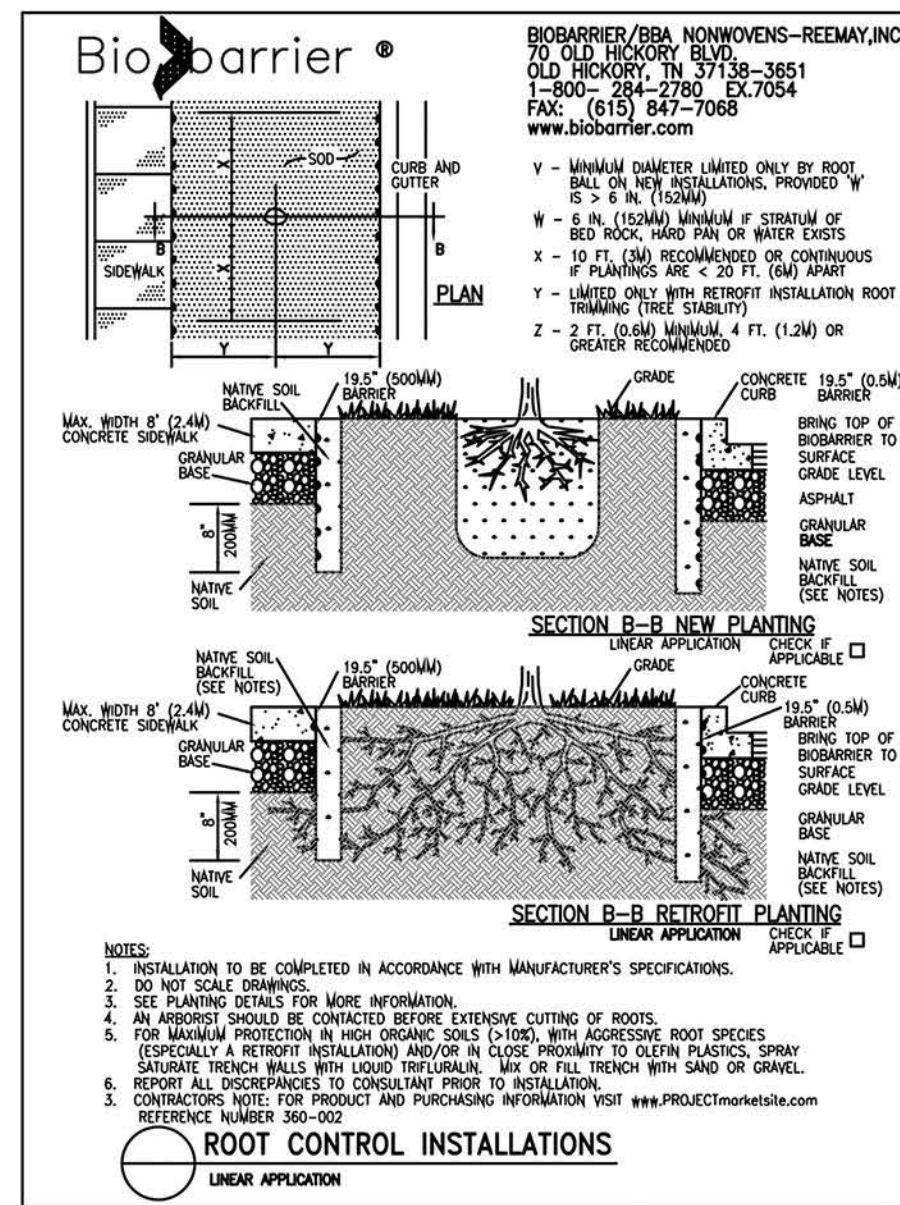

**TYPICAL ROOT BARRIER INSTALLATION**  
 NOT TO SCALE

**ROOT CONTROL INSTALLATIONS**  
 CIRCULAR APPLICATIONS

**ROOT CONTROL UTILITY LINE INSTALLATIONS**  
 SINGLE UTILITY LINE PROTECTION WITH WEED CONTROL

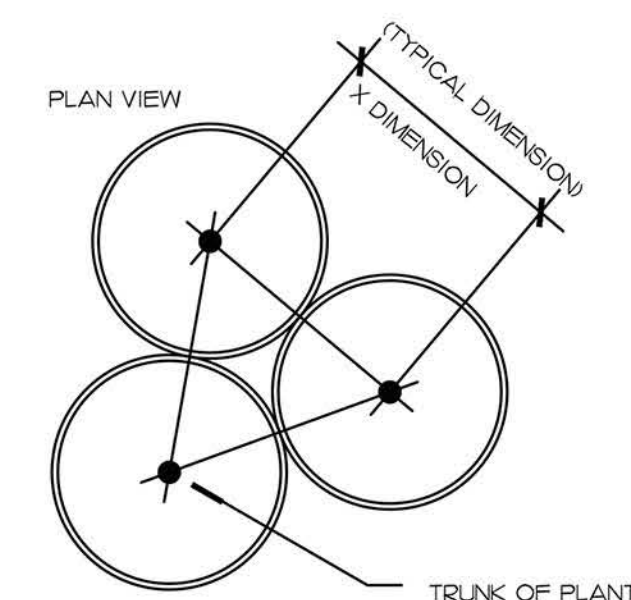

**TYPICAL PLANT SPACING DETAIL**  
 NOT TO SCALE

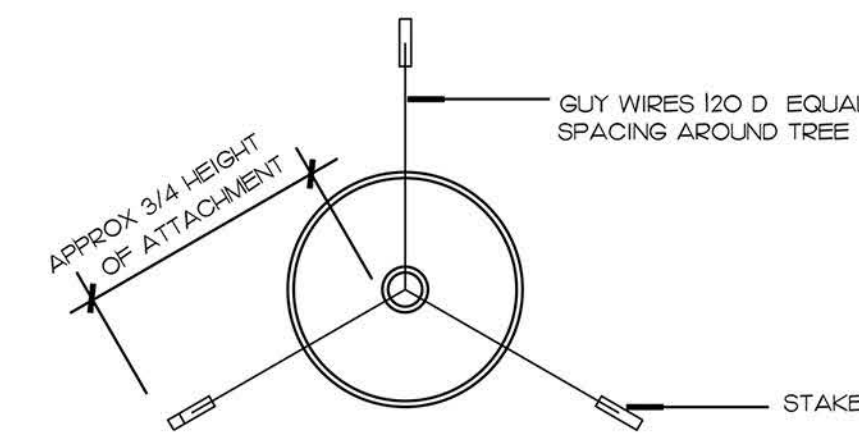

**TYPICAL TREE GUYING DETAIL**  
 NOT TO SCALE

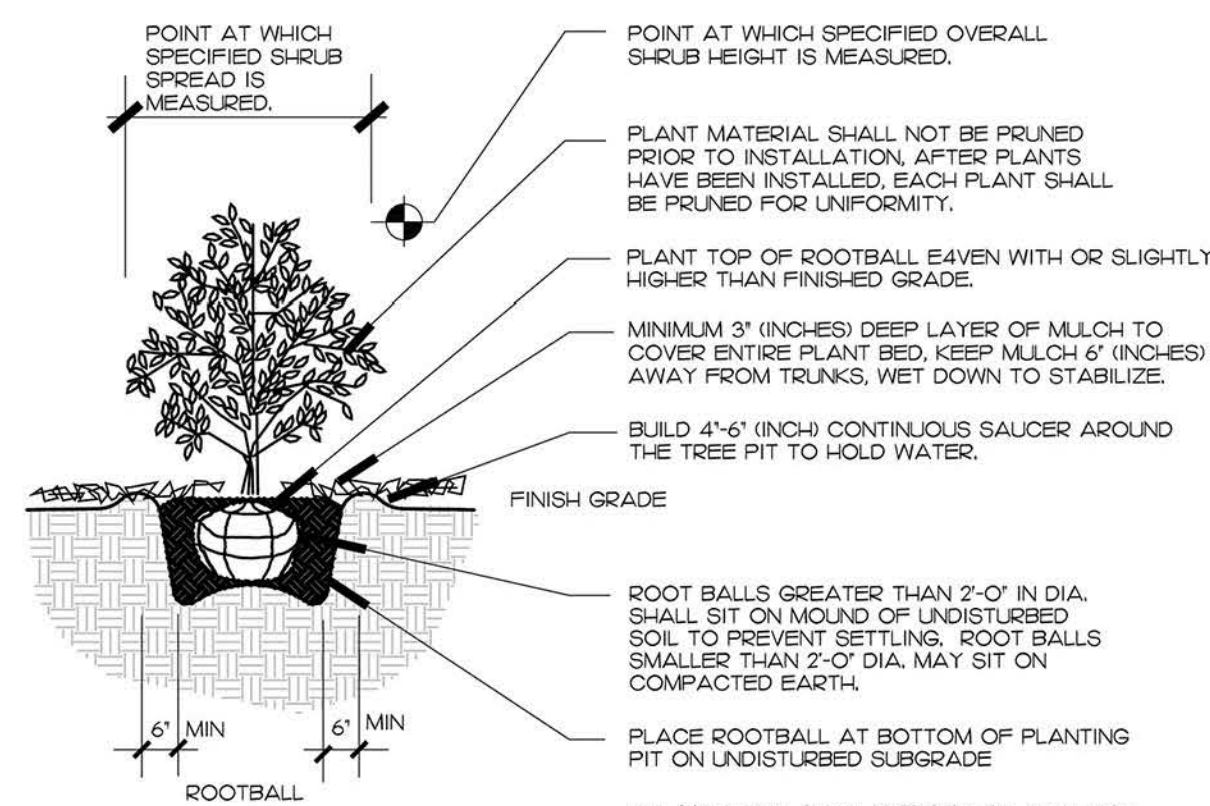

**TYPICAL SHRUB/ GROUNDCOVER PLANTING DETAIL**  
 NOT TO SCALE

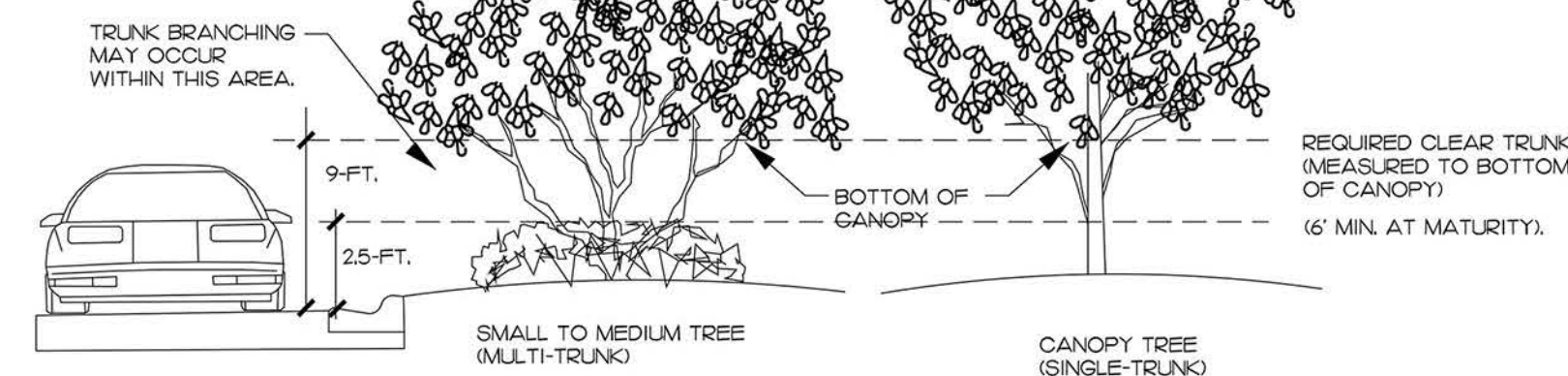

**CLEAR TRUNK WITHIN SIGHT TRIANGLE DETAIL**  
 NOT TO SCALE

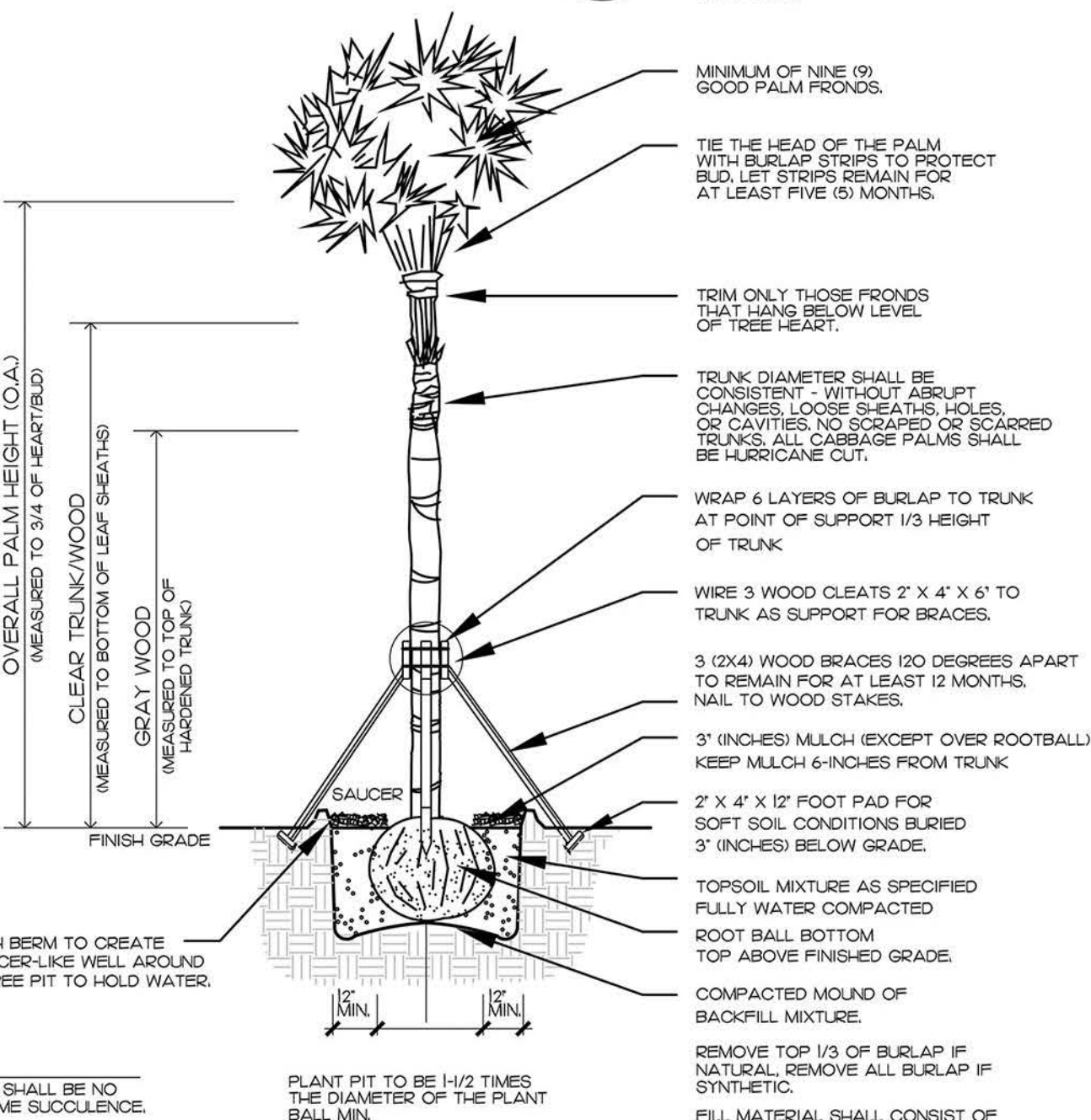
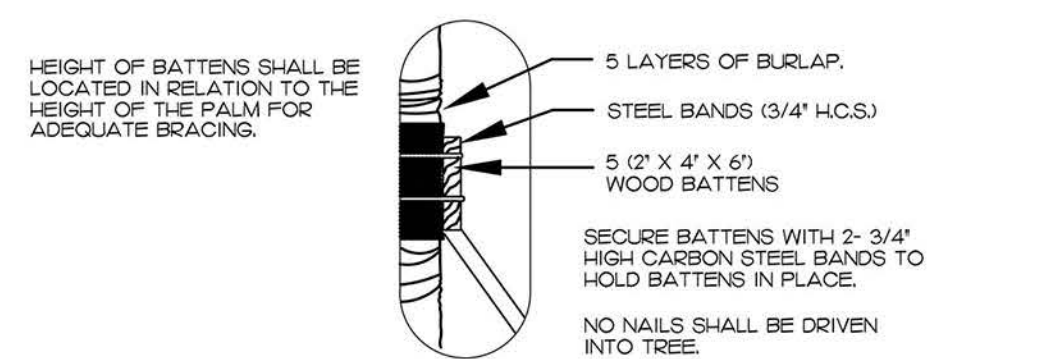

**TYPICAL PALM PLANTING DETAIL**  
 NOT TO SCALE

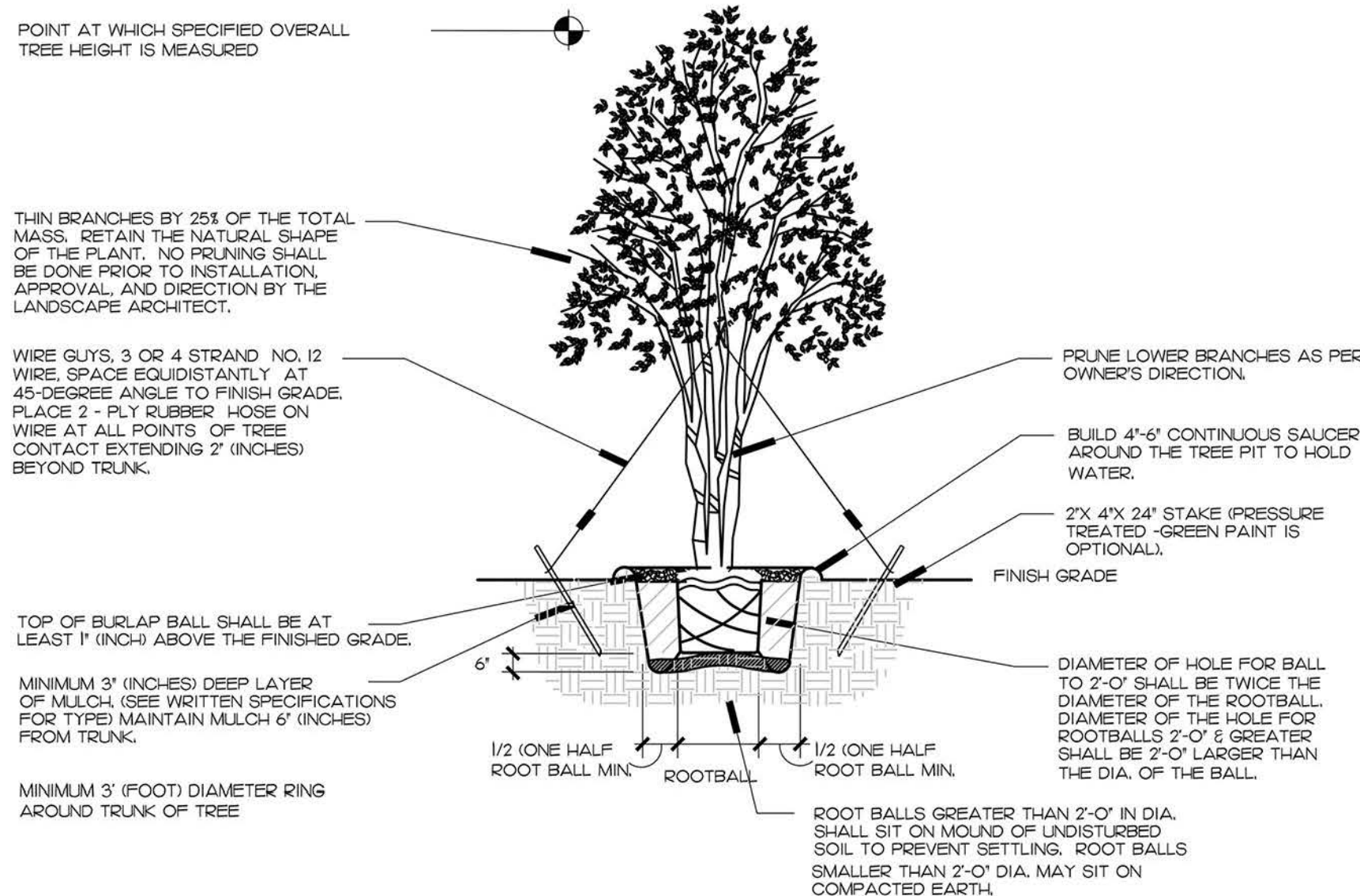

**TYPICAL IRREGULAR/MULTI-TRUNK TREE PLANTING DETAIL**  
 NOT TO SCALE

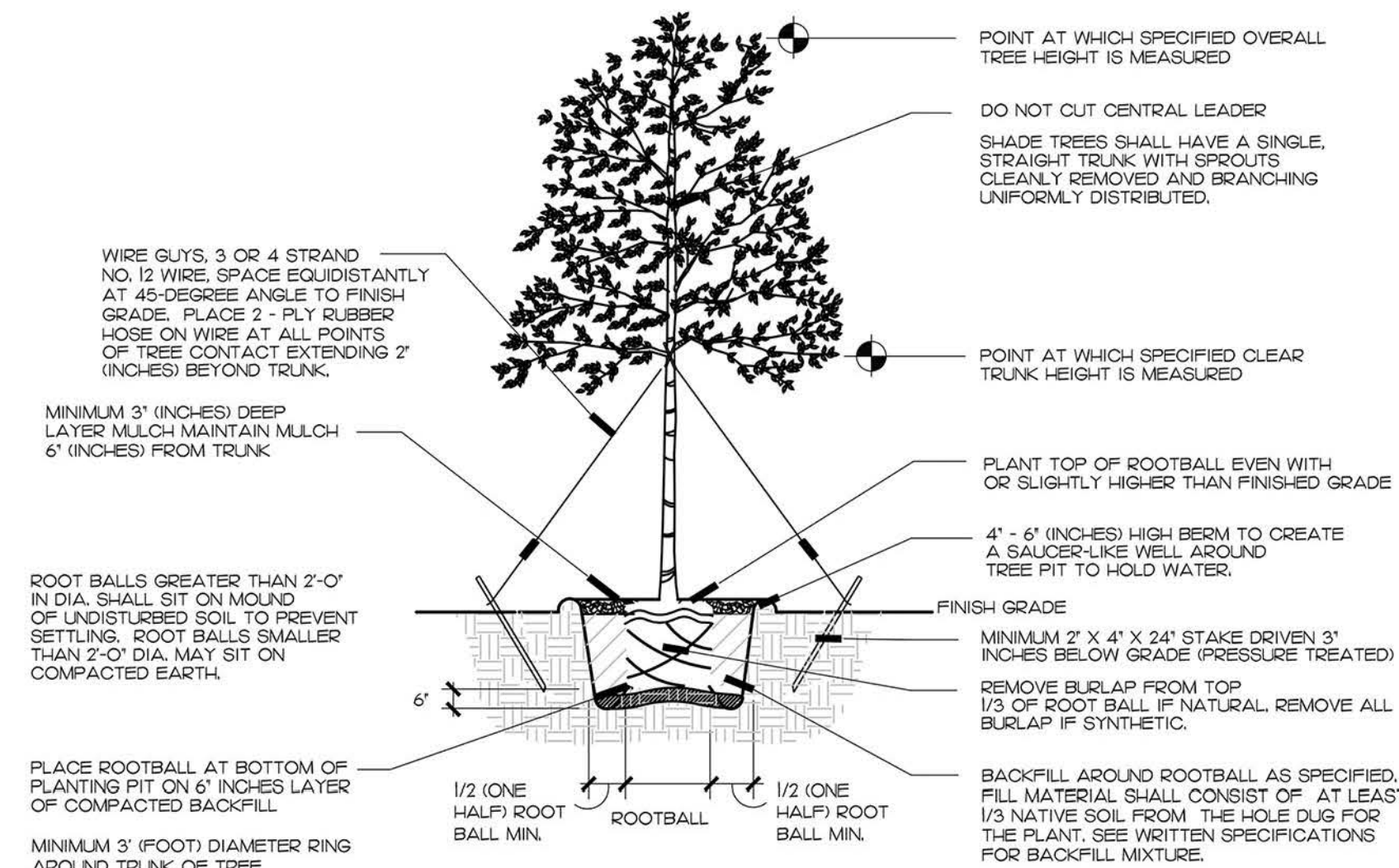

**TYPICAL TREE PLANTING DETAIL**  
 NOT TO SCALE

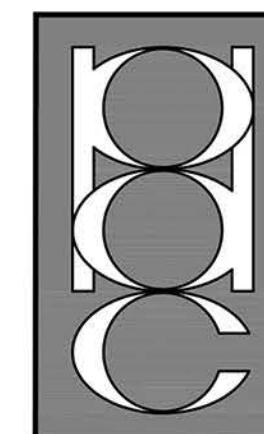
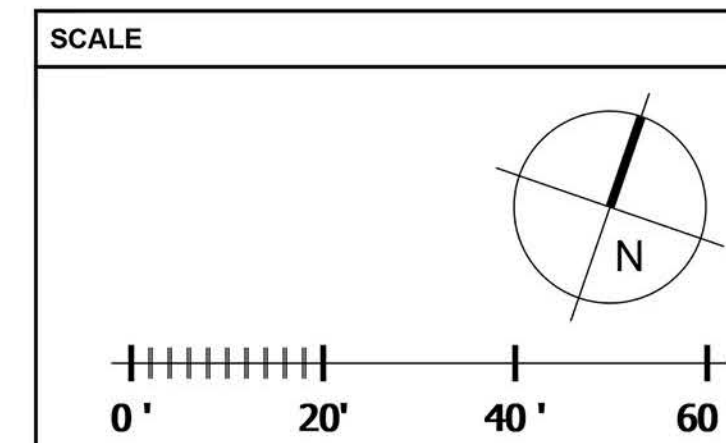

**PATRICK D. CUNNINGHAM, LLC**  
 ■ landscape architecture  
 ■ land planning  
 519 Sapphire Drive  
 Sarasota, FL 34234  
 O: 941.351.8915  
 pcunningham.LLC@gmail.com

**bdg**  
 architects

201 South Tryon Street  
 Suite: 525  
 Charlotte, NC 28202  
 P: 704.981.8951  
 Lic. #: AA-0003590  
 www.bdgllp.com



**FIFTH THIRD BANK**  
 CORKSCREW ROAD  
 BRANCH  
 10870 MIROMAR OUTLET DRIVE  
 ESTERO, FL 33928



**INFINITY ENGINEERING GROUP, PLLC**  
 1208 East Kennedy Boulevard  
 Suite 230  
 Tampa, FL 33602  
 [p]: 813.695.4649  
 [f]: 813.445.4211  
 www.ieggroup.net  
 Certificate No. 27889  
 IEG JOB NO. 15-160.00

SEAL PATRICK D. CUNNINGHAM  
 FL. REG. NO. LA 0001669



11.23.2020  
 DATE

ISSUE/BY	DATE	DESCRIPTION
	08-17-20	PERMIT SET

**PROJECT INFORMATION BLOCK**  
 JOB #: 193504  
 DATE: 08-17-2020  
 DRAWN BY: PC  
 CHECKED BY: PC

**SHEET TITLE**

**LANDSCAPE DETAILS**

**SHEET NUMBER**

**LP03.01**

48 HOURS BEFORE DIGGING  
 CALL TOLL FREE  
 8-1-1  
 SUNSHINE.COM  
 NOTIFICATION CENTER