

Attachment A  
**Site Plan**

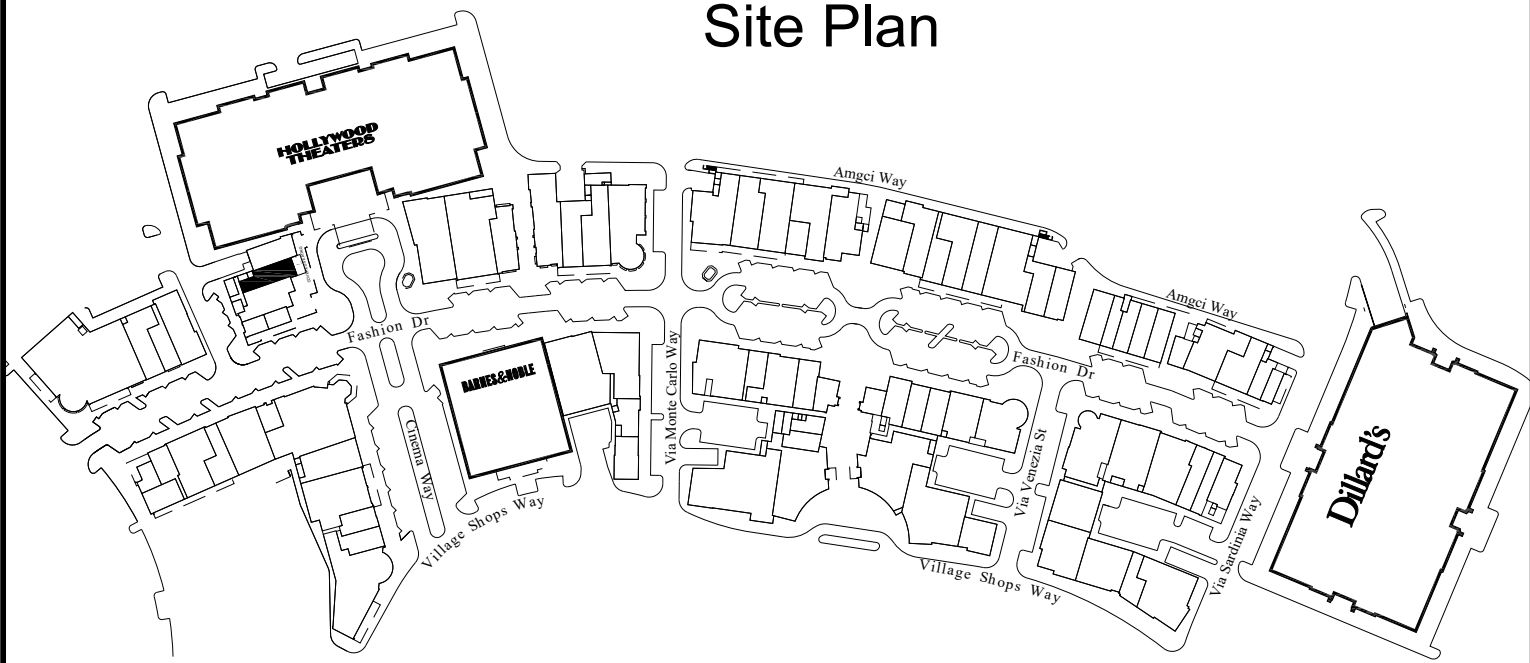

**COCONUT POINT**

TSD# K11-13  
 Level: 01



Simon Property Group  
 225 W. Washington St.  
 Indianapolis, In 46204

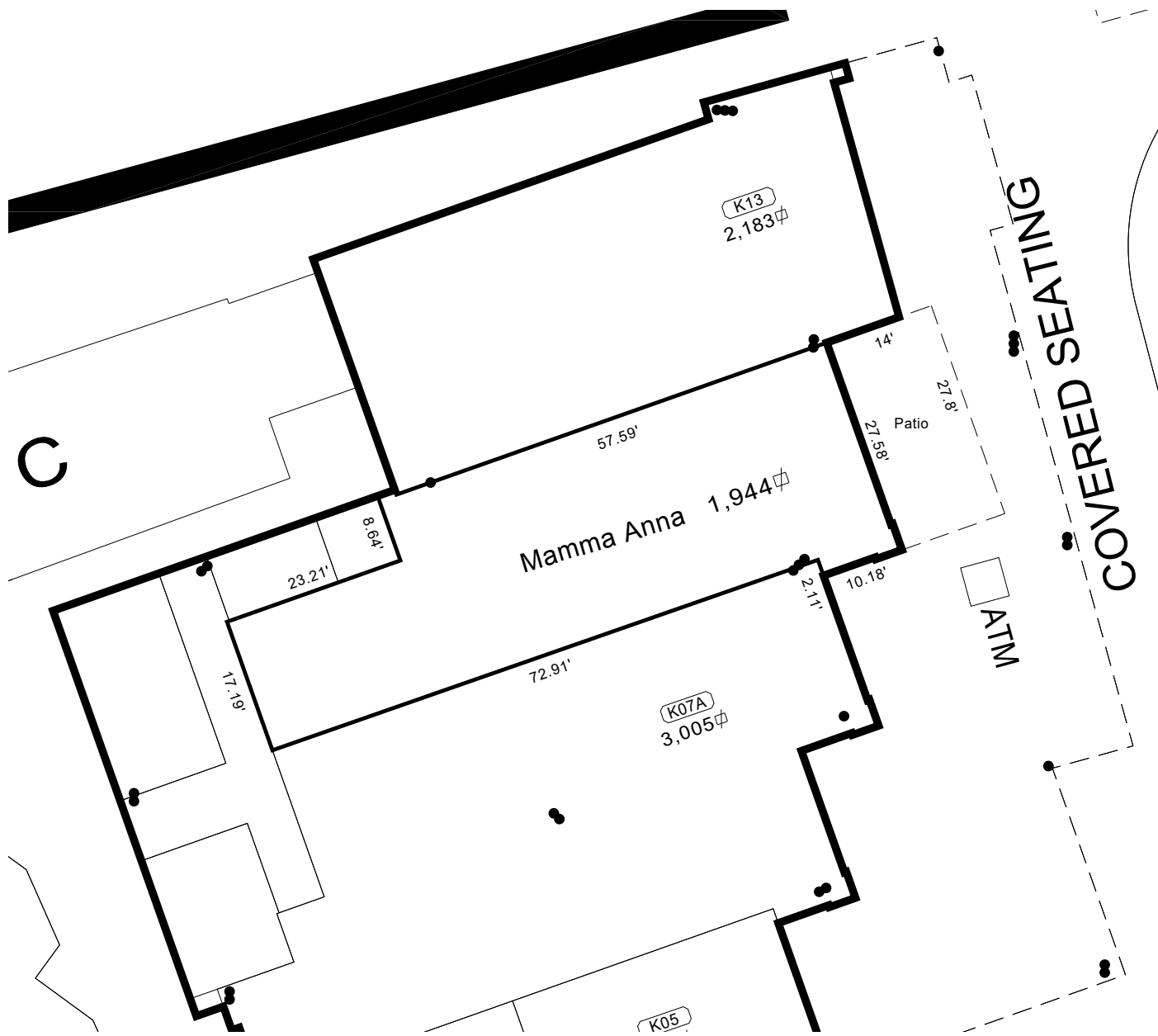

S:\ACAD\CORP#4696\CP\4696CP.dwg

S:\acad\corp#4696\tsd\4696\_K11-13.dwg

The information in this document is confidential and a proprietary trade secret of the Landlord and may not be copied, distributed, published or disclosed without prior written permission. Landlord retains the right to design, change, alter or modify (without prior written notice) the size and configuration of any or all of the Center or any of the buildings, premises, hallways, malls, corridors, kiosks, tenant spaces or common areas contained therein, including, but not limited to, the identity, size, configuration, location or arrangement of any of the foregoing. This document does not constitute any contract or obligation by the Landlord. Landlord makes no representations or warranties regarding the Center, any premises contained therein, or the accuracy of the information contained in this document. It is the responsibility of Tenant or Tenant's contractor to field verify existing site conditions and dimensions.

DBA Name:  
 Unit No.109  
 Leasing Agent:

Date: 12/12/2019  
 Scale: 1" = 20'  
 Corp. No. 4696